

# The Guilford News

GUILFORDASSOCIATION.ORG

WINTER 2012

## Frederick Law Olmsted, Jr. – *The Plan for Guilford*

PART 4 IN THE GUILFORD HISTORY  
SERIES AS WE COUNT DOWN TO THE  
CENTENNIAL CELEBRATION IN 2013

The Directors of the Guilford Park Company, determined to create a garden suburb of the highest quality, engaged the Olmsted Brothers to prepare the plan for development of the Guilford community.

The Olmsted Brothers company was the foremost landscape firm in the country. Its principals were Frederick Law Olmsted, Jr. and John Charles Olmsted, the son and stepson of the late Frederick Law Olmsted, the dean of American landscape architects and founder of the firm, designer of Central Park, numerous other city park systems, great estates and plans for many noted institutions.

Frederick Law Olmsted, Jr. was the principal who primarily worked on the Guilford plan and landscape design. He was a highly respected designer, widely regarded as the intellectual leader of the American city planning movement in the early twentieth century. In 1901, he was appointed by President Theodore Roosevelt as a member of the McMillan Commission to plan for the restoration of the Washington Mall and other aspects of the L'Enfant plan for Washington. He had a lifetime commitment to national parks and planned many of them; he designed park systems for many cities, including Baltimore and he designed a number of planned communities.

When the Guilford Park Company acquired the Abell estate, the City already had on paper a plan to continue the grid street system north throughout the estate property. Such a plan would have disregarded the topography and devastated the lush forested areas. The Directors rejected such a plan and were determined that there should be a green garden suburb reflecting the value of the countryside supplied with urban conveniences but removed from the city's "congestion, noise, crime and vice."

Olmsted was a proponent of garden suburbs in America where people live harmoniously together with nature, a concept advocated by Ebenezer Howard in England. The Guilford site was surveyed and existing trees and vegetation were inventoried in detail. He laid out streets to follow contours of the land, preserve stately trees and valued vegetation and generally enhance the natural beauty. Traffic was to be concentrated on a few wide streets with pedestrian walks along well planted areas. Most roadways were to be quiet and safe with traffic channeled to the thoroughfares.

See **OLMSTED PLAN**, page 4

This preliminary Olmsted plan dated 1911 closely resembles the final street layout of Guilford. The street names, however, are very different. Names like Orchis (Greenway), Basil (Highfield Rd.), Clover (Lambeth Rd.), Laurel (Kemble Rd.), Aralia (Stratford Rd.), Lobelia (Wendover Rd.), and Sundew (Chancery Rd.) never found their way to the final design.

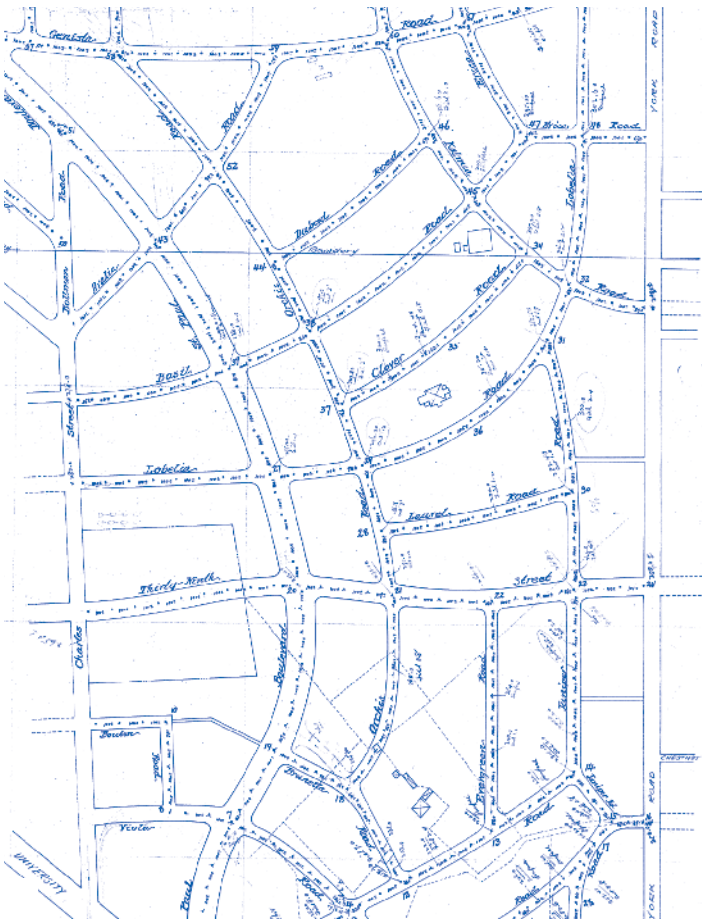

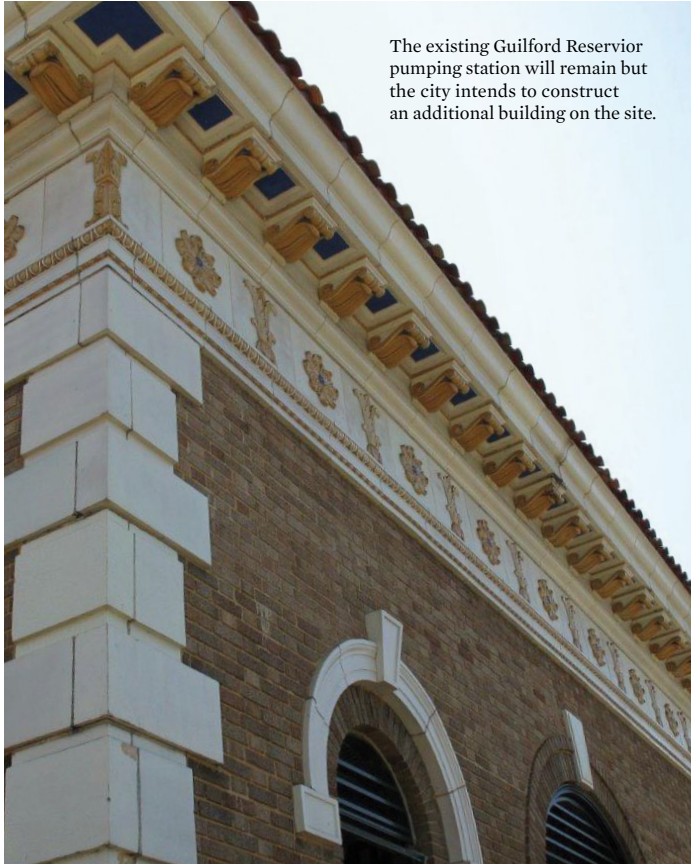

The existing Guilford Reservoir pumping station will remain but the city intends to construct an additional building on the site.

## Winter 2012 Update

On November 16th the Guilford Association held its Annual Meeting. It was an opportunity for me and other Board members to report on activities and issues of the past year as well as outline some plans for the future. For those who were not in attendance I'll summarize those comments.

A first order of business was the election of new Board members. The Association is managed by a 20-member Board of Managers and one-quarter of the Managers are elected for a period of 4 years at each Annual Meeting. New Board members are: Sharon Smith (4100 Greenway), Elizabeth Comer (4303 N. Charles Street), Dee Smith (14 E. Bishops Rd.) and Geoff Lord (4100 St. Paul St.). Tim Chriss (4306 Greenway) was re-elected to the Board. A list of all Board members, information on Board committees and Board member's email contact information can be found on the Guilford web site.

In December, the Board of Managers elected the following officers for 2012: Tom Hobbs, President; Lynda Riley, Vice President; Dee Smith, Secretary; Heather Fones, Treasurer.

**Association Office.** In Spring of 2011, the Association opened our Guilford Association office at 4200 Saint Paul St. within the Second Presbyterian Church complex. Computer systems are now in place to maintain our books and records and Association files that have been scattered are being assembled in this one location. Michelle Trousdale is the part-time office manager. The office

phone number is 410-889-1717 and the Association can be accessed by email at [guilford@guilfordassociation.org](mailto:guilford@guilfordassociation.org) or [officemanager@guilfordassociation.org](mailto:officemanager@guilfordassociation.org). The quarterly meetings of the Association Board of Managers are now held in the Westcott Room at Second Presbyterian.

**Guilford Reservoir.** The City Bureau of Water has continued preparing plans to encapsulate the reservoir water in tanks. Initially it was proposed that the tanks be exposed. The Association and community residents strongly objected concluding that such a plan would have a severely negative effect on the historic Guilford community. In response, the City has agreed to bury the tanks and cover them with a landscaped park-like area.

Representatives from the Board and the blocks surrounding the reservoir have been meeting with Bureau of Water representatives and their design consultants as the plans are being developed. Three options were initially presented by the designers and a revised plan is being prepared that should reflect community comments. When reviewed by the committee the plan will be available for community view.

**Pumping Station.** Related to the alterations of the Guilford Reservoir, the City intends to construct on the existing pumping station site an additional new building for emergency generation and replacement of the liquid chlorine treatment. The existing architecturally significant pumping station will remain but the new building would replace the two adjacent brick buildings. The City did not share this proposal with the community until design was well advanced. The Association Architectural Committee objected to the scale, positioning and proposed servicing of the building. When the proposal was reviewed by the City's Commission for Historical & Architectural Preservation (CHAP), the Commission members agreed with the Association concerns and rejected the proposed design.

**Loyola Expansion.** Loyola has now completed the expansion of the Donnelly Center and the Association thanks the University for re-designing and landscaping both sides of the Charles Street and Cold Spring Lane intersection.

**Communication.** The Association has increased electronic communication with residents through the use of Constant Contact and the enhanced newsletter. Residents are invited to comment and contribute and residents that may not have provided the Association their email address are urged to do so that they will receive announcements.

**Guilford's Centennial.** In May 2013 we begin the celebration marking Guilford's centennial year. Many activities are being planned to mark the 100th year and we encourage and invite participation by all. Ann Giroux is coordinating activities and discussion of some of the plans is covered elsewhere in the newsletter.

**Budgets.** The sound financial position of the Association and adequate resources to carry out the responsibilities under the Deed and Agreement are primary concerns of the Board. With the changes made in the billing and collection process two years ago that follow the prescription of the Deed and Agreement, we are in a much improved cash position to cover the needed operations throughout the year. Heather Fones, the Association Treasurer, reviewed the 2011 financials and presented the proposed 2012

## 2012 Guilford Association Budget Summary

### REVENUES

Maintenance charges & Association dues	212,027
Other Income ( <i>Guilford Security Patrol, York Court, Block 32 Park</i> )	146,300
<b>Total Income</b>	<b>358,327</b>

### EXPENSES

Contracts — Guilford Security Patrol ( <i>membership pass-through</i> )	140,000
Contracts ( <i>Parks, Rent, York Court, St. Paul Median</i> )	73,100
Newsletter	5,700
Administrative ( <i>accounting, legal, wages, tax, snow removal, repairs, postage, supplies, insurance</i> )	84,400
Stratford Green transfer	50,000
Contingency/Reserve	5,127
<b>Total Expenses</b>	<b>358,327</b>

## 2012 Stratford Green Budget Summary

### REVENUES

Guilford Association transfer	50,000
Annual Appeal	20,000
Other fund raising and donations	37,550
<b>Total Income</b>	<b>107,550</b>

### EXPENSES

Contracts ( <i>maintenance, irrigation, planting</i> )	56,000
Utilities	3,350
Tulips	16,000
Administrative ( <i>adopt-a-plot, wine tasting, etc.</i> )	32,200
<b>Total Expenses</b>	<b>107,550</b>

budgets for the Guilford Association and for Stratford Green. Both are break-even budgets and they were adopted by the Board of Managers at the Annual Meeting.

**Community Safety.** Much of the focus of the Annual Meeting was on community safety and a discussion of the increased criminal activity in Guilford during the summer months. Major Sabrina Tapp-Harper and Deputy Major Rich Worley of the Northern District were both present to review the additional police coverage of Guilford, actions that residents can take and to hear concerns from the residents present. City Council members Mary Pat Clarke and Bill Henry were also present and participated in this discussion. Felix Dawson, chair of the Association's Safety Committee summarized the activities of the Guilford Security Patrol and actions that were being taken to improve the GSP service.

Because of the time devoted to security issues, some of the committees of the Board did not present detailed reports but that information is available as an attachment to the minutes and in the newsletter.

You will observe that for the first time advertisements are included in the Guilford News. The Board decided to accept limited advertisements on a trial basis as a means of covering some of the cost of the newsletter. Printing and the cost of postage increase and while we are distributing the newsletter electronically, many residents have requested that the print version continue as well. Please let us know your thoughts.

A wealth of information about Guilford's history has been discovered as we work on the planned book about our community. We hope that the brief history articles that are appearing in the newsletter give some indication of the rich heritage here. We are still looking for people to relate personal knowledge of Guilford and its residents over the years or provide early photographs. If you have material to contribute, please contact Ann Giroux.

May the mild winter that we've had through January continue. Guilford in the Spring will soon be upon us.

Tom Hobbs



**BARTLETT.**  
**BECAUSE CUSTOMER SERVICE,**  
**JUST LIKE TREES, SHOULD BE**  
**A BREATH OF FRESH AIR.**

We're Bartlett Tree Experts and we've been exceeding our customers' expectations for over 100 years. No matter the size or scope of your tree and shrub needs, our experts bring a rare mix of local service, global resources and innovative tree care practices that makes your landscape thrive. Trees add value to our homes and our lives. And Bartlett adds value to your trees.



**BARTLETT**  
**TREE EXPERTS**

SCIENTIFIC TREE CARE SINCE 1907

*For the life of your trees.*

PRUNING . FERTILIZATION . PEST & DISEASE MANAGEMENT . REMOVAL  
 PLEASE CALL 877 BARTLETT 877.227.8538 OR VISIT [BARTLETT.COM](http://BARTLETT.COM)



**MTARX**  
 .com

**Melville Thomas Architects, Inc.**  
 ARCHITECTURE & PLANNING

600 Wyndhurst Ave ■ Suite 315 ■ Baltimore, MD 21210

TEL: 410.433.4400 FAX: 410.433.4719

E-MAIL: [info@mtarx.com](mailto:info@mtarx.com)

**MTARX**  
 .com





**7 WHITFIELD RD**  
List Price: \$895,000  
Closing Price: \$825,000



**10 OVERHILL RD**  
List Price: \$549,000  
Closing Price: \$540,000



**4405 GREENWAY**  
List Price: \$1,125,000  
Closing Price: \$1,025,000

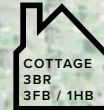

**4412 NORWOOD RD**  
List Price: \$457,000  
Closing Price: \$440,000



**4307 N. CHARLES ST**  
List Price: \$1,100,000  
Closing Price: \$1,092,000



**5 STRATFORD RD**  
List Price: \$689,000  
Closing Price: \$645,000



**4004 GREENWAY**  
List Price: \$789,900  
Closing Price: \$839,900



**3915 JUNIPER RD**  
List Price: \$469,000  
Closing Price: \$455,000



**201 KEMBLE RD**  
List Price: \$525,000  
Closing Price: \$480,000



**3807 GREENWAY**  
List Price: \$695,000  
Closing Price: \$650,000



**225 CHANCERY RD**  
List Price: \$459,900  
Closing Price: \$459,000



**309 SUFFOLK RD**  
List Price: \$379,170  
Closing Price: \$379,000



**207 SOUTHWAY**  
List Price: \$435,000  
Closing Price: \$411,000



**3511 NEWLAND RD**  
List Price: \$329,000  
Closing Price: \$312,000

## Active Properties

AS OF FEBRUARY 20, 2012

	List price
<b>11 YORK CT</b>	\$125,000
<b>18 YORK CT</b>	\$170,000
<b>4418 EASTWAY</b>	\$250,000
<b>316 SOUTHWAY</b>	\$325,000
<b>3504 NEWLAND RD</b>	\$374,000
<b>3803 JUNIPER RD</b>	\$375,000
<b>4419 UNDERWOOD RD</b>	\$399,000
<b>1 STRATFORD RD</b>	\$549,000
<b>206 CHANCERY RD</b>	\$630,000
<b>101 CHARLCOTE RD</b>	\$699,000
<b>4205 CHARLES ST</b>	\$765,000
<b>211 HIGHFIELD RD</b>	\$765,000
<b>4415 BEDFORD PL</b>	\$784,500
<b>9 CHARLCOTE PL</b>	\$795,000
<b>201 ST MARTINS RD</b>	\$859,000
<b>12 ST MARTINS RD</b>	\$955,000
<b>4202 GREENWAY</b>	\$1,250,000

Guilford property sales data is from MRIS (Metropolitan Regional Information Systems, Inc.) and was provided courtesy of John A. Menton III, Coldwell Banker Residential Brokerage, 10807 Falls Road #300, Lutherville, MD 21093. Phone: (410) 971-7160. Email: JMenton@cbmove.com

# Guilford Property Sales

SEPTEMBER 1, 2011 – FEBRUARY 20, 2012



## Guilford, a garden suburb.

COURTESY U.S. COMMISSION OF FINE ARTS

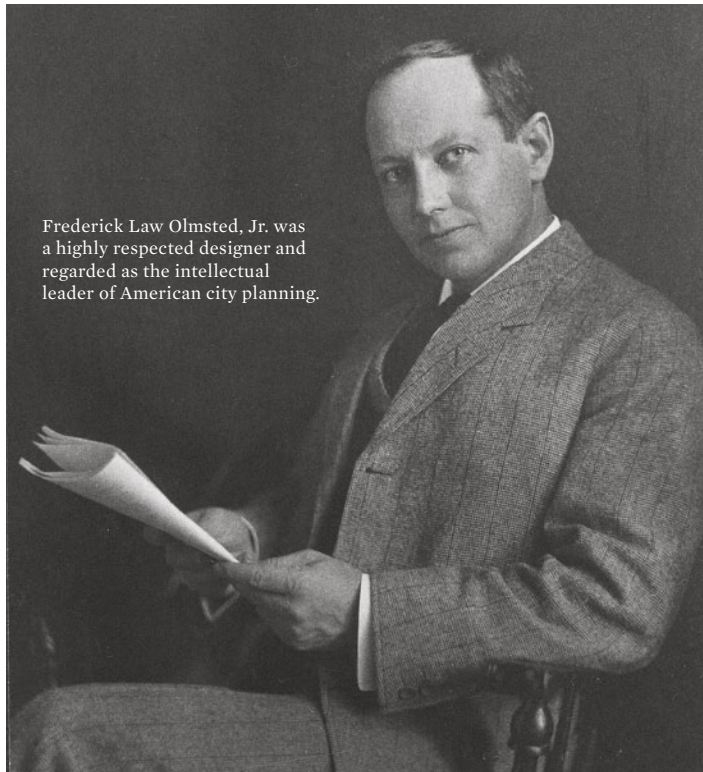

Frederick Law Olmsted, Jr. was a highly respected designer and regarded as the intellectual leader of American city planning.

### OLMSTED PLAN, From page 1

When the Guilford Park Company merged with the Roland Park Company there was no question that Frederick Law Olmsted, Jr. would continue as planner and landscape designer. He had designed the western portion of Roland Park and he and Edward Bouton, now the president of the Roland Park Company, had consistent ideas about the development of the garden suburb and specifically the objectives for Guilford. They also were working together on Forest Hills Gardens, the Russell Sage Foundation developed planned community, outside of New York City. There Bouton was general manager, concurrent with his role as president of the Roland Park Company, and Olmsted was the planner and landscape designer. Olmsted also was engaged in other Baltimore projects, including the design for the Johns Hopkins Homewood campus, the Charles Street approach to Guilford and a plan for the Baltimore park system.

When the Roland Park Company took over the development of Guilford in 1911 plans were sufficiently prepared for the company's engineers to design the infrastructure systems and begin detailed designs for the roadways. Olmsted continued to refine the design and prepared road and landscape designs for each block of Guilford. As the Roland Park Company information brochure for potential buyers indicates: *"The planting of trees and shrubs in the parks and sidewalk lawns, along slopes and in other unoccupied spaces, has been made a distinctive feature of Guilford. The plans for this planting have been developed by Mr. Olmsted in the form of a carefully studied unified design for the whole property. . . ."*

*Unusual care has been taken in the designation of the trees and shrubs to be used."*

Of great importance to Olmsted in his designs for new communities was "the separateness and internal integrity that would promote tranquility and give rise to the development of a sense of 'shared community' among their residents." In addition to the general lush planting and walkway system, three community parks were planned (the Sunken Park, Stratford Green and the Little Park). In addition, Olmsted introduced private parks, little parcels of land spotted in the centers of many Guilford blocks as further evocations of "natural" land.

There were other conditions unique to the Guilford site that required careful consideration by Olmsted and Bouton. The Episcopal Diocese had purchased a site at the southwest edge of Guilford on which it planned to build a large, twin-towered cathedral, requiring Olmsted to plan options for both the cathedral site and the important southern entrance to Guilford. All along the eastern edge of the site on the east side of Greenmount Avenue/York Road was the grid street pattern and unplanned development; on the north was Cold Spring Lane and uncertain development. To address the issue of the north edge of the site that abutted Cold Spring Lane, Olmsted used "back-turning" streets at Whitfield Road, Bedford Place and Charlcote Place. English cottage houses were built along the eastern end surrounding a private "close."

The eastern edge of the Guilford site presented a greater challenge. It was here that the Roland Park Company undertook initial development, building the architecturally admired Tudoresque houses of Bretton Place and Chancery Square, creating an internally focused English village-like environment. Handsome and setback row houses were built along Greenmount Avenue to the south and the homes of York Courts surrounding private green spaces were built to the north.

At the Olmsted National Historic Site in Brookline, Massachusetts there are over 500 drawings and records covering the Guilford plans. In addition there are relevant Olmsted records at the Smithsonian and many additional records related to the planning among the Roland Park Company files now at the Johns Hopkins Library. These all are being searched for the planned book on Guilford.

Both Olmsted and Bouton were committed to the importance of protective covenants as the best means for assuring "stability" and "permanence." Without control on development, they had observed high quality single family communities transformed by conversion to multi-dwelling and commercial uses and value change and character loss. Nuisance laws and design guidelines had proven to be insufficient protection against decline and change. Deed restricted covenants, including design controls, they argued protect purchasers against unwanted change that might "destroy the setting and they assure long-term well-being." The collaborative work of Bouton and Olmsted in refining protective covenants became a model for similar provisions that are still widely used.

At the presentation of the Pugsley Gold Medal Award in 1953 honoring champions of parks and conservation, it was observed



Dated 1908 this drawing shows the city's intent of continuing the street grid system through Guilford.



This early street plan was completed for the Guilford Park Company prior to 1911 when it merged with the Roland Park Company.

*"Carrying on the ideals of his father, and with many of his father's special qualities and characteristics, Olmsted was an outstanding leader in advancing landscape architecture to a status of honor and recognition among the professions. Indeed, for over a half-century Olmsted was the preeminent practitioner and spokesman for landscape architecture and comprehensive planning both interested in the interrelationship of people and their environment."*

Olmsted summarized his philosophy about landscape architecture in the following terms: *"In dealing with existing real landscapes, I have been guided by an injunction impressed on me by my distinguished father: namely, that when one becomes responsible for what is to happen to such a landscape his prime duty is to protect and perpetuate whatever of beauty and inspirational value, inherent in that landscape, is due to nature and to circumstances not of one's contriving, and to humbly subordinate to that purpose any impulse to exercise upon it one's own skill as a creative designer."*

Guilford residents and the City of Baltimore are the fortunate beneficiaries of Olmsted's insight and design skills, living in and with one of the country's most admired and lasting communities.



DRAWING COURTESY BALTIMORE ARCHITECTURE FOUNDATION



The architectural firm of Wrenn, Lewis, Westenhover, and Jencks designed a number of the homes in Guilford. Their archive includes many watercolor and pencil renderings such as this one for 9 St. Martin's Road.

This view of Baltimore was taken from the original Guilford estate. The group of photos are from an Abell family album and are believed to have been taken sometime between 1876 and 1880.



PHOTOS COURTESY CHARLES HALL

## Guilford Centennial Update

ANN GIROUX

The Guilford centennial is fast approaching and everyone has been working to prepare for this milestone year. In the past few months, the committee continues to acquire historic materials documenting the early years of our community, firmed up plans for centennial year events, developed fundraising strategies for Stratford Green and laid the groundwork for a few fun extras for centennial year.

The committee has been focusing on collections of historic archival material including photographs, drawings, artwork, newspaper articles and other items of interest. Much of this material will be considered for the book highlighting the historical relevance of Guilford.

We are urging residents in possession of their original architectural plans, or copies of their original plans to please contact us. We would like to scan details from these plans for the publication. Unfortunately, The University of Baltimore Langsdale Library, which holds the majority of Guilford's architectural plans, has a fee schedule which makes large scale copying cost prohibitive.

Please contact Ann Giroux directly with questions about Guilford Centennial by phone (410) 889-6484 or email [aggiroux@girouxdevelopment.com](mailto:aggiroux@girouxdevelopment.com).

Here is a teaser of what has been uncovered in the last couple of months:

- > Drawings and sketches showing the development of Guilford from the Olmsted archives in Brookline, Massachusetts
- > Watercolor and pencil illustrations by the architectural firm Wrenn, Lewis, Westenhover, and Jencks
- > Photographs documenting early street construction from the Maryland State Archives
- > Photograph album documenting the construction of Guilford containing over one hundred images.
- > Photographs documenting the old Abell estate from the Maryland Historical Society
- > Photographs documenting Sherwood Gardens "back in the day" from the Smithsonian





Pinehurst

[www.PinehurstLandscape.com](http://www.PinehurstLandscape.com)

Let Pinehurst design or enhance the gardens around your home this Spring with their award-winning designers and horticulturalists. Whether you wish to bring new life to an old flower bed or start fresh with a custom design we will make your dream of a Beautiful Outdoor Living space come true.

Master Planning & Design/Build • Large Tree Installation • Maintenance  
Retail Nursery • Natural Stonework • Masonry • Outdoor Kitchens • Fireplaces

4809 Long Green Road • Glen Arm MD • (410) 592-6766



[www.fickbros.com](http://www.fickbros.com)



## We do **MORE** than just roofing !!!

Fick Bros offers a variety of exterior and interior services. All of our services are performed with our own in-house trained and experienced crews, guaranteeing you the same reliable craftsmanship and expertise you have come to expect from the Fick family over the past 96 years.

### Roofing Services

Slate & Tile Roofs  
Synthetic Slate Roofs  
Wood Shingles & Shakes  
Asphalt Shingles  
Metal Roofs  
Flat EPDM (Rubber) Roofs  
Repairs & Replacements  
Skylights & Sun Tunnels  
Roof Ventilation  
Custom Metal Fabrications  
Gutters & Downspouts  
Gutter Leaf Guards  
Gutter Cleaning Service  
Leak Investigation & Repair  
Roof Inspections  
Maintenance Contracts



### Exterior Services

Masonry Repairs  
Stucco Repairs  
Chimney Repairs  
Cupolas & Weather Vanes  
Siding Repair & Installation  
Soffits  
Decking  
Carpentry Repairs  
Porch Railings  
Rotted Wood Replacement  
Azek "PVC" Trim  
Minor Exterior painting  
Windows & Doors  
Pressure Washing  
Inspection & Maintenance  
Handyman Repairs



### Interior Services

Attic Insulation  
Drywall & Plaster Repairs  
Window & Door Repairs  
Molding Installation  
Minor Interior Painting  
Carpentry Repairs  
Handyman Repairs



**410-889-5525**



## Gateway Park's New Resident—Maryland's Wye Oak

“State tree” of Maryland, oldest and largest White Oak in the Country, the Wye Oak stood in Talbot County on Maryland's Eastern Shore for 460 years before succumbing to a thunderstorm in 2002.

Maryland's first forester and an early leader in forest conservation, Fred Besley, first measured the Wye Oak, helped establish a state park for its protection and eventually a national program to identify, celebrate and protect monumental trees.

Interest in this particular White Oak went beyond bragging rights, the tree's ability to resist blight and infection made it prime stock for reforestation efforts. Before it fell, the Department of Natural Resources had been collecting acorns and raising Wye Oak saplings, one of which is now in Gateway Park. Watch in the spring as its leaves first emerge a remarkable silvery-pink coated in a soft down.

While the Wye Oak's trunk was 31' in circumference, with branches that spread out 120', don't worry about ours overtaking the park any time soon. Another White Oak on the north end of Gateway Park, along Greenway, has taken 20 years to reach its current, relatively small stature.

The tree was planted by Oakenshawe residents Mark & Susie Counselman.

## Board Recognizes 2011 Donations to Stratford Green

We are all grateful for the generous donations to Stratford Green by the following people and businesses. Without these additional monies for the planting and maintenance, Sherwood Gardens would not have looked as beautiful as it has in 2011. If there are any errors in names, amount donated or omissions, please let the Guilford Office know by e-mail ([officemanager@guilfordassociation.org](mailto:officemanager@guilfordassociation.org)) or phone 410-889-1717. If you would like to make a donation to Stratford Green, please send a check made payable to “Stratford Green” c/o Guilford Association, 4200 St. Paul Street, Suite 100, Baltimore, MD 21218.

### \$10,000 – 15,000

Felix and Deborah Dawson

### \$5,000 – 9,999

Brendan and Nathalie Collins  
The Pennyghael Foundation

### \$1,000 – 4,999

Bruce and Amy Barnett  
CANUSA Corporation  
Howard and Joan Friedel  
David and Ann Giroux  
London Foundation Inc.  
Ancelmo Lopes and Barbara Hill  
Miller Wood Products  
Landon and Joan Royals  
The Joseph Mullan Company  
Wells Enterprises T/A  
The Wine Source

### \$500 – 999

Mark and Beth Felder  
Joseph and Deborah Finnerty  
Jonathan and Gail Fishman  
Paul Fowler and Frank McNeil  
Tom and Robin Hobbs  
John Holtzman and  
Karen Beasley  
Anne Hopkins  
Charles and Julie Kernan  
Mercedes-Benz USA, Inc.  
Adam and Merritt Miller  
James and Mary Miller  
Renaissance Fine Arts  
Darrell and Lynda Riley  
Seth Stevens and Scott Stanton  
Alexander and Susan Stewart  
Bill and Michelle Trousedale  
Judy Witt

### \$250 – 499

David Archey and Kelly Dooley  
Artsee Fartsee Inc.  
Patrick and Lori Brady  
Francisco and Shawn Castellanos  
Dan and Betty Chemers  
Kristina Gregory and  
Christopher Phipps  
Bruce and Lindsay Fleming  
Andrew and Heather Fones  
Elke Franke  
Glyndon Lord Baltimore  
Kirk Design Inc.  
Rosario and Margaret Llarro  
Geoffrey and Ellen Lord  
M & T Investment Group  
James and Leslie Meek  
David and Betsy Nelson  
Stephen Parker and  
Virginia Larsen  
Ralph Partlow and Jeanette Glose  
Stanley and Vera Platman  
Charles Reeves  
Oliver Schein and Nadine Fontan  
Winston and Marilyn Tabb  
George Taler and Cyndy Renoff  
The F.A. Bartlett Tree Expert Co.  
John Urbaitis and  
Barbara Matheson  
Peter and Fauzia VanDermeer

### \$100 – 249

Christopher Abularrage and  
Maureen Marsh  
Stanton and Renee Ades  
Julia Arfaa  
Stephen and Carole Argo  
Bruce and Pam Babij  
Baltimore Community  
Foundation  
Ken and Margo Bates  
Michael O'Pecko and  
Dyer Bilgrave  
Becky Bittinger and  
Lynne Heidelberg  
Michael and Emily Brennan  
Tom and Peggy Brennan  
Charles and Betsy Bryan  
Andrew and Lynn Brynes  
Julie Carter  
Mark Chartrand and  
Hugh Jaramillo  
Michael Ankrom and  
FW. Chickering  
Scott and Kimberly David  
Michael and Andrea Dennehy  
William Dixon  
Quan Dong and Diana Do  
Mario and Johanna Eisenberger  
Frederic Emry III  
Hartley and Randal Etheridge  
Mike Fall and Peggy Sparr  
Jose and Ginger Galvez  
Alan and Lisa Garten  
Kevin and Cathy Gaynor  
Joanna Davison Golden  
Patrick Hagerty and  
Jennifer Broussard  
Brian and Tracy Harrington  
Ron and Anne Heaton  
D.A. and Nana Henderson  
Payne and Pamela Hindsley  
Tim Holland and Troy Piro  
Douglas and Mimi Horensky  
Ken Hubbard  
John and Linda Hutchins  
Richard and Pat Jacobs  
Sasha Koo-Oshima  
Matthew and Sally Ann Koontz  
Lawrence LaMotte and  
Shirley Bigley  
Peter and Eleanor Landauer  
Peter Lees and Christine Schmitt  
Boaz Leung  
David and Merrill Levin  
Richard Lewin  
Paul and Beth Matsko  
Joe and Katie McAvoy  
Michael and Jennifer McDevitt  
Gustave and Maria McManus  
Christian Montgomery  
Charles and Marcia Moylan  
Christian Pavlovich and  
Tedine Ranich  
Mark and Joanne Pollak  
Edward and Hannah Reahl  
Michael Rosenbaum and  
Amy Kiesel  
Ingo Rucinski and  
Elizabeth Sugar  
Sebeniecher Insurance Inc.

Steven and Susan Shattuck  
Benjamin and Elmeretta Shelton  
Steve and Anne Simms  
Richard Slaven  
Ronald and Gail Spahn  
Charles and Margaret Supik  
Christopher and Andrea Taylor  
The George McManus  
Foundation  
George and Millicent Tyler  
Unity Health Services  
Bernard and Maliene Wajer  
James and Jane Webster  
Thomas Weisser and  
Margaret Alton  
Roy Wise and Maggie Bruck  
Fred and Peggy Wolf  
Richard and Jacqueline Wolfe  
Joseph and Imelee Zebley

### \$1 – 99

A. Lewis Manufacturing Co.  
Jim Williams and Stuart Berger  
Maurice and Zita Bessman  
Judith Greenwood Brown  
Peter and Paula Burger  
Curtis and Paula Campbell  
Chris and Laura Clarke  
Mark and Jacqueline Donowitz  
Jim and Sharon Dorrian  
Anne Dugan  
Douglas and Joyce Forsyth  
James and Vicki Fuller  
Loretta Garfinkle  
Geoffrey Genth and Rachel Eisler  
Charles and Brigitte Harper  
Clarinda Harris  
Richard and Nina Jones  
Michael and Jennifer Labellarte  
James and Johanna Lewis  
Phil and Kelly Maher  
Howard and Linda Maltz  
Luke and Nancy Marbury  
Mark and Erin McCarthy  
Mark McMullen and  
James Morrison  
H. Mebane and Ivana Turner  
Aaron Meisner  
Martin and Patricia Merritt  
Jane Meyer  
Joy Munster  
William and Katherine Murphy  
William and Patricia Murphy  
Margaret Musgrove  
Samual Peters and Suzanne Hurst  
Bruce and Patrice Preston  
Eric Rice and Sarah Kanchuger  
Jesus Rivera and Leigh Kramer  
Paul Sarbanes  
William Shinn and  
Millicent Tyler  
Bernard and Marsha Shutt  
Mark Sissman and  
Barbara Squires  
Joel Spruck and Ellen Robbins  
Jerry and Carrie Thornberry  
Douglas Watson and  
Estelle Gauda



---

# Gardeners of Guilford

## Q&A

With spring around the corner, the Garden Club reached out to Dorothy Wells, a master gardener, to answer some questions we have had during the season.

**Q: DURING HURRICANE IRENE, A TREE FELL ONTO MY PROPERTY, FELLING SOME OF MY NORWAY MAPLES AND A SUGAR MAPLE. I'D LIKE TO FIND SOME OPTIONS THAT WILL GROW QUICKLY AND OFFER SOME PRIVACY, AS WELL AS ABSORB THE TRAFFIC NOISE. I LIKE THE MAPLE'S FALL COLOR AND THE SHADE IT PROVIDES, BUT IT DOESN'T REALLY DO ANYTHING INTERESTING IN THE SPRING OR WINTER. CAN YOU SUGGEST SOME ALTERNATIVES?**

**A:** Norway Maples are considered invasive species in Maryland because they are very prolific seeders, spreading seedlings in fields and woods, choking out native trees. Now is your opportunity to replace it with a better tree. An evergreen tree might be a good choice for your privacy concern since the traffic will continue after the leaves fall. I am especially fond of sweet bay magnolia as an evergreen. To replace the shade tree, I would suggest you read the University of Maryland's description of native trees at [http://www.hgic.umd.edu/\\_media/documents/NativePlantsOfMD.pdf](http://www.hgic.umd.edu/_media/documents/NativePlantsOfMD.pdf) and choose a tree that meets your needs for mature size, speed of growth, sun and moisture availability. It is also nice to get more than one season worth of interest out of a tree, meaning flowers in the spring, nice summer foliage, pretty fall color and nice structure or interesting bark in the winter.

**Q: I'VE SEEN AROUND THE NEIGHBORHOOD TREES THAT LOOK GREAT THROUGH MID-SUMMER AND THEN SUDDENLY TURN BROWN — WHY IS THAT? WHAT SPECIES ARE REALLY VULNERABLE TO ILLNESS/OTHER ENVIRONMENTAL CONDITIONS HERE? WHAT TREES SHOULD I AVOID PLANTING?**

**A:** Some trees were stressed last summer from the lack of rain and incredible heat but I was told your browning could have been caused by a fungal disease that likes horse chestnut trees. As long as the fungal disease causes the browning late in the season, it should not cause a problem for the tree to recover next season. Some buckeyes, same genus, different species, may be more or completely resistant to the fungal disease. The University of Maryland also has information about symptoms, causes and control of tree diseases in the publication [http://www.hgic.umd.edu/\\_media/documents/hg61.pdf](http://www.hgic.umd.edu/_media/documents/hg61.pdf). Other diseases coming down the interstate involve ashes, walnuts, and maples.

**Q: IT FEELS LIKE IT TAKES FOREVER FOR TREES TO GROW, AND ALTHOUGH I KNOW I'M SUPPOSED TO TAKE INTO CONSIDERATION THE FULL MATURE SIZE OF THE TREE WHEN I PLACE IT ON MY PROPERTY, IT ALWAYS LOOKS SO OFF. HOW MATURE A TREE CAN I PLANT WITHOUT BREAKING THE BANK OR RISKING THE TREE? ARE THERE SPECIES**

**THAT WILL GROW FASTER THAT I CAN CHOOSE? OR ARE THERE WAYS I CAN LANDSCAPE WITH THE TREE TO MAKE IT LOOK BETTER IN MY LANDSCAPE?**

**A:** It does take a long time for a tree to grow, so hopefully you will plant a tree this year. It is best to start with a tree that has a 1 to 1.5 inch diameter trunk that has been in a pot at least 12 inches in diameter. The smaller tree will adapt more easily to your yard, and it will actually grow more quickly than if you planted a larger tree. If the tree is larger than that, there is a good possibility the tree's roots are circling in the pot. The girdled roots will have to be cut off before planting and the tree will need to recover. It is easier for a tree to be transplanted young so it can spread its roots in every direction in your yard, instead of a pot. Some trees grow faster than other trees, however a fast growing tree might have weaker wood and might be more susceptible to wind damage. Faster is not always better.

**Q: I'VE HEARD IT'S BETTER TO PLANT TREES IN THE FALL? IS THIS TRUE? WHY? WHAT IF I CAN'T WAIT? HOW SHOULD I TAKE CARE OF IT IF I AM PLANTING THIS SPRING?**

**A:** It is best to plant a tree in early fall or early spring. Some trees including oaks actually prefer to be planted in the spring. Both early spring and fall planting allows the tree to establish root growth before the severe cold of winter or the drying heat of summer. A young tree needs to be faithfully watered about 20 gallons (a slow run of the hose for 1/2 hour) every week during the growing season for the first two years. This is especially true for the first summer following a spring planting.

**Q: WHAT ELSE SHOULD I KEEP IN MIND WHEN CHOOSING A TREE FOR MY GARDEN?**

**A:** 1) Choose a tree based on the mature size of the tree, taking into consideration power lines above and your home below. "The right plant for the right spot" also applies to trees. 2) Plant the tree at the right depth. Dig a hole that is wide but not too deep. After the soil settles, the trunk flare should be above the soil line. If it looks like you planted a telephone pole, dig up the tree and replant it higher. 3) When transplanting the tree, cut off girdling and circling roots. These roots will never straighten out and will only cause the tree stress as it gets larger. 4) Refill the hole with the soil that came out of the hole. Do not add amendments to the soil. If you refill the hole with nice loose amended soil, when it rains, the rain will stay around the tree and will not drain out into the yard. The tree roots will rot. 5) Allow the tree to grow without competition. Surround the tree with an area of mulched soil. Even grass will rob your tree roots of water and nutrition. 6) Use no more than an inch of mulch. Do not make a mulch volcano. 7) Go to <http://www.hgic.umd.edu/content/documents/HG202HomeownerLandscapeSeriesPlantingProblemsOfTreesandShrubslowres.pdf> for additional tree planting information.

The Baltimore City Master Gardeners are part of the University of Maryland Extension and have referenced some of the very useful and scientifically supported documents provided on the University of Maryland HGIC website. Homeowners are encouraged to reference this site because it is a wealth of information. If you have another question like the fungal browning question, you can also call the HGIC staff Monday–Friday, 8 a.m.–1 p.m.(ET) at 800-342-2507. You can take a picture of the problem plant and they will research your specific problem. It takes out the guess work.

# Security Shortfall

LYNDA RILEY

ADDITIONAL **95** HOUSEHOLDS NEEDED  
TO MAINTAIN SECURITY COVERAGE

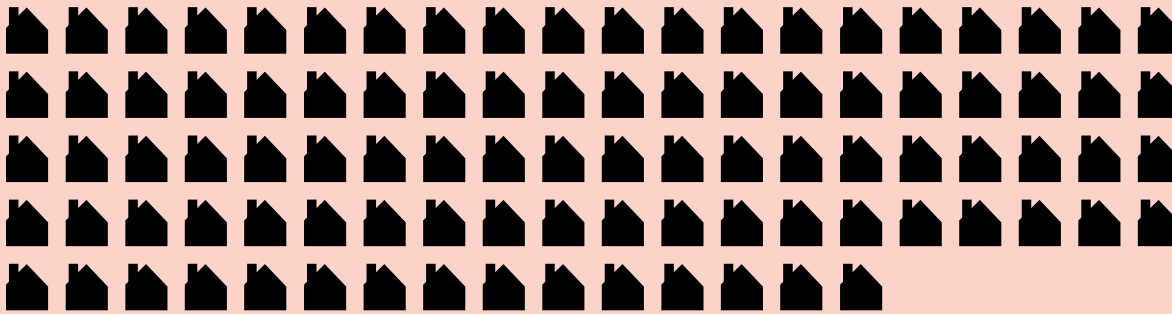

During the past summer there was a significant up-tick in crime events in the Guilford community. At the Annual Meeting of the Association in November, the Major of the Baltimore Police Department's Northern District reported that the increase was reflected throughout the Northern District but that the increase seen in Guilford was evident. A number of actions have been taken by the police and the GSP in an effort to combat crime and assure safety in the community.

The number of serious crimes in Guilford remained the same in 2010 and 2011. In 2010 there were two armed robberies, an abduction of a student and a home invasion. All of these incidents occurred within one block of Greenmount Ave. In 2011 there were three home burglaries in an expanded area of the neighborhood and a rape on Greenmount Ave.

However, minor incidents tripled from 2010 to 2011 increasing from 22 to 66 incidents. These incidents include garage break-ins, car break-ins, vandalism, broken windows and property stolen from a porch. There was a rash of garage break-ins, particularly along Northway, during the summer of 2011.

Members of the Guilford Board during the summer met with the Northern District Police Major and Deputy Major and with Mary Pat Clarke to devise a strategy to halt this crime wave. Patrols were increased and two officers were assigned to work with the Guilford community. Since the end of the summer criminal activity is down and it is fairly quiet now. A man was arrested and accused of both the attempted attack of two women in Gateway Park in January 2012 and the later attempted robbery of two joggers.

The Guilford Security Patrol, working with the Baltimore City Police, have provided additional survey of the community, particularly when the police patrol car is not on the scene, and together with the police patrol has been helpful in keeping the crime down. The GSP security vehicle driving through the neighborhood is a deterrent and has been helpful in limiting the criminal activity. The GSP car positions itself outside of Guilford Elementary and Middle School at dismissal time to prevent youths from roaming our streets. The GSP guards also have been helpful in picking up newspapers when people are away, picking up packages and moving them out of sight, checking on vacant houses, returning lost dogs to their owners, removing solicitors from the neighborhood, responding to calls about suspicious persons, and returning a lost child on Halloween night.

Unfortunately, voluntary payments to the Guilford Security Patrol are down. To maintain coverage from 10 am to 2 am seven days a week we need \$140,000. At this point we have collected \$109,109. We need 95 more households to join the GSP or people who have already paid to donate more money to sustain the existing coverage. For every additional \$25 received we can keep the guard on our streets for one more hour. The rate of the GSP officers ranges from 17.00 to 25.00 per hour — higher number is for holidays. We used to have 24/7 coverage over the weekend, but those hours were reduced last year because fewer people paid the GSP fees. Please help by paying the GSP fees of \$325 per year and by convincing your neighbors to participate.



# Welcome New Neighbors

We are delighted to welcome the following neighbors who became Guilford residents in 2011:

John and Janine Conant, 307 E. Highfield Road  
Mary Alice McCall and Joan Cox, 4402 Eastway  
Brian and Evie Edwards, 4308 Wendover Road  
Anthony Gill and Tracey Clark, 309 Suffolk Road  
Kerunne Ketlogetswe and Ivan Sheehan, 4417 Norwood Road  
Aaron Meisner and Jessica Karaska, 207 Southway  
Geraldine Seydoux, 4412 Norwood Road  
Victoria and Osman Bengur, 4410 Norwood Road  
Matthew Chambers and Noreen O'Brien, 3915 Juniper Road  
Susan Heether, Catherine Kelly and Ann Marie Snyder,  
225 Chancery Road  
Charles Peace IV, 201 Kemble Road  
Ted and Bonnie Ochs, 10 Overhill Road  
Yanko and Ashley Kranov, 265 Stratford Road  
Julia Arfaa, 4334 N. Charles Street  
Benton Jay Komins and Reha Erzurumlu, 3807 Greenway  
Jennifer Hinkle, 214 Northway  
George and Jennifer Persky, 203 Lambeth Road  
Richard and Nina Jones, 7 Whitfield Road  
Andre Campbell and Edward Epure, 4004 Greenway  
John and Lisa Horrigan, 4313 Saint Paul Street  
Thomas Kelso and Dorothy Bishop, 4204 Greenway  
Helan Pesano, 4307 N. Charles Street  
Christian Pavlovich and Tedine Ranich, 4005 Greenway  
James and Tracy Godey, 4410 Greenway  
Stephen and Frances Davis, 3805 Greenway  
Scott and Kimberly David, 207 E. Highfield Road  
Michael and Catherine Stokes, 3511 Newland Road  
Douglas Hamilton and Angela Luncznski, 223 Chancery Road

## Upcoming Welcoming Party

Each year, the Guilford Welcoming Committee hosts a brunch for neighbors who are new to the neighborhood. This year's event will be held on March 4th. If you are new to the neighborhood and have not received an invitation, please contact: Millicent Tyler at [millieandgeorge@comcast.net](mailto:millieandgeorge@comcast.net).

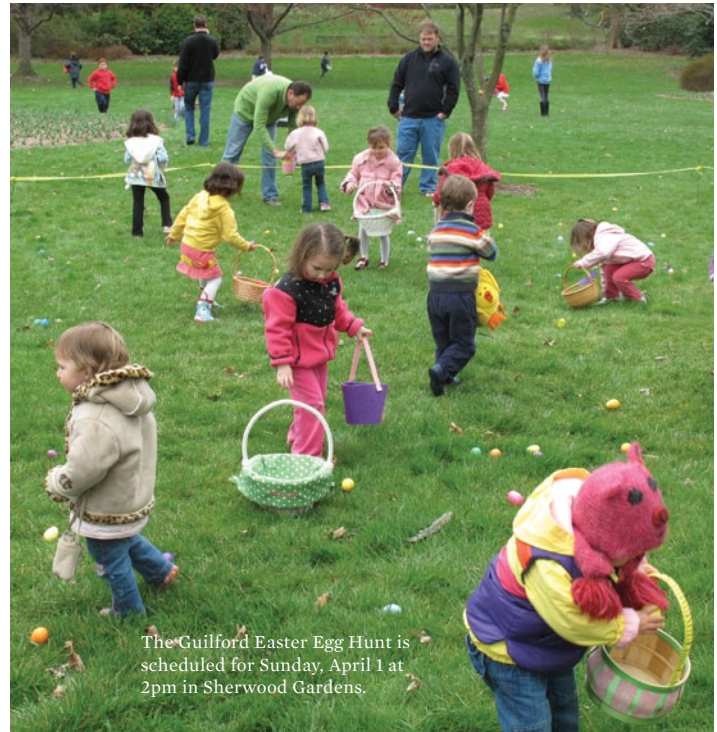

The Guilford Easter Egg Hunt is scheduled for Sunday, April 1 at 2pm in Sherwood Gardens.

## Wine Tasting

This past year's wine tasting was held on Saturday, October 22nd. It was a lovely evening and approximately ninety guests walked the short distance from Jeff and Nicole Lubin's home on St. Paul's street to dinner at Cathy and Kevin Gaynor's home on Warrenton and, finally, to dessert at Jeff Nelson and Mary Rifino's abode on Whitfield.

Caterer, Beej Flamholz prepared a contemporary Middle Eastern feast that was paired with wines selected and served by the Mt. Washington Wine Company. One guest was overheard saying that the food and wine had never been better.

A special thanks to the homeowners who kindly opened their homes for this annual fundraiser for the gardens, and to the volunteers and guests who made the evening such a success.

For neighbors interested in helping this year, please contact Ann Tyler at [tylershinn@aol.com](mailto:tylershinn@aol.com).

## Holiday Party

The Women's Civic League's holiday party at the home of Dr. Paul Fowler and Frank McNeil, Jr. was quite a festive affair according to guests. For a small fee, approximately 125 neighbors each brought an appetizer and enjoyed an open bar and live music. The Woman's Civic League donates the proceeds of this event to Sherwood Gardens.

### Guilford Association Board

#### President

Tom Hobbs  
[tom@guilfordassociation.org](mailto:tom@guilfordassociation.org)  
410-889-1717  
Architecture

#### Vice President

Lynda Riley  
[lynda@guilfordassociation.org](mailto:lynda@guilfordassociation.org)

#### Secretary

Dee Smith  
[dee@guilfordassociation.org](mailto:dee@guilfordassociation.org)

#### Treasurer

Heather Fones  
[heather@guilfordassociation.org](mailto:heather@guilfordassociation.org)

#### Office Manager

Michelle Trousdale  
[officemanager@guilfordassociation.org](mailto:officemanager@guilfordassociation.org)

Margaret Alton  
[margaret@guilfordassociation.org](mailto:margaret@guilfordassociation.org)  
Parks

Bruce Barnett  
[bruce@guilfordassociation.org](mailto:bruce@guilfordassociation.org)  
Sherwood Gardens

Cathy Boyne  
[cathy@guilfordassociation.org](mailto:cathy@guilfordassociation.org)  
Reservoir

Tim Chriss  
[chriss@guilfordassociation.org](mailto:chriss@guilfordassociation.org)  
Legal

Elizabeth Comer  
[elizabeth@guilfordassociation.org](mailto:elizabeth@guilfordassociation.org)

Felix Dawson  
[felix@guilfordassociation.org](mailto:felix@guilfordassociation.org)  
Safety

Howard Friedel  
[howard@guilfordassociation.org](mailto:howard@guilfordassociation.org)

Ann Giroux  
[ann@guilfordassociation.org](mailto:ann@guilfordassociation.org)  
Centennial

Jeremy Hoffman  
[jeremy@guilfordassociation.org](mailto:jeremy@guilfordassociation.org)  
Newsletter

Larry LaMotte  
[larry@guilfordassociation.org](mailto:larry@guilfordassociation.org)

Geoff Lord  
[geoff@guilfordassociation.org](mailto:geoff@guilfordassociation.org)

Bernie Shutty  
[bernie@guilfordassociation.org](mailto:bernie@guilfordassociation.org)  
Traffic & Parking

Peter Smith  
[peter@guilfordassociation.org](mailto:peter@guilfordassociation.org)

Sharon Smith  
[sharon@guilfordassociation.org](mailto:sharon@guilfordassociation.org)

Ann Tyler  
[anntyler@guilfordassociation.org](mailto:anntyler@guilfordassociation.org)  
Neighborhood Events

#### Newsletter Editor

Kristina Gregory  
[kristinaegregory@yahoo.com](mailto:kristinaegregory@yahoo.com)

## FANS Welcomes Dynamic, New Principal to Guilford

NANCY GETTER

FANS [Friends and Neighbors of our School], are delighted to report on the many exciting changes taking place at our neighborhood school. To begin, last spring a small group of teachers, administrators, parents, and community members from Guilford Elementary/Middle School had the honor and privilege of interviewing candidates for the school's new principal. After talking with several qualified candidates, one candidate stood out as the perfect person for the position, Mr. Brian Jones. Mr. Jones started as Guilford's new principal this past summer, and he has made tremendous changes and improvements from the moment he walked through the door.

The positive changes kept coming in August as the children returned to a newly named school, Guilford Elementary/Middle School for Art and Technology, with new requirements of personal conduct and new school uniforms. Now, every student is called a scholar and every scholar and his or her parent(s) or guardian(s) have signed a school compact with the principal that lays the foundation of expectations for academic excellence.

There's a new full-time art teacher, a new full-time music teacher, a new full-time physical education teacher, and a part-time computer instructor. Scholars have physical education, art, music, and technology classes every week. In addition, the school offers a

wide variety of both in school and after school activities such as STEM (Science, Technology, Engineering and Math), Girl Scouts, Acts4Youth, After School Science, basketball, dance, tennis, choir, math club, graphic design and the National Academic League.

Enrollment has gone from 321 students to 354, and attendance at PTO meetings has increased. Word is spreading quickly that exciting, effective, positive changes are happening at the school. Helping Mr. Jones reach his goal of a technology focused school, three organizations, the Federal Drug Administration, BootUp Baltimore, and Loyola University, have donated computers.

This January, the school kicked off its first recycling program, and two new academic enrichment programs will be offered during the spring semester: Camp Achieve and BootUp Baltimore. Last fall saw the school's first Spelling Bee while the new semester offers the first Math Jeopardy contest for scholars from first to eighth grade.

Eleven Guilford and Homeland residents now tutor at the school. Tutors work with scholars in all different age groups and subject areas. Some tutors work one on one with a child, work with the scholars in small groups. This year's FANS Tutors are Amy Barnett, Julie Evans, Nancy Getter, Jay Lippincott, Margaret Lippincott, Claudia Nemphos, Leslie Meek, Gillian Meigs, Burton Ray, Lynda Riley, and Susan Scheir. If you would like to tour the school, serve as a FANS Tutor or support the school in any other way, please feel free to contact Nancy Getter at [kgetter@aol.com](mailto:kgetter@aol.com) or 443-895-4255. FANS members are Jim Durkay, Beth Felder, Nancy Getter, Bess Keller, Joy Munster and Lynda Riley.



# OMALLEY

AMERICAN, ENGLISH & CONTINENTAL ANTIQUES



**NEW EXPANDED SHOWROOM**

**18th, 19th, and early 20th century**

fine furniture, oil paintings, mirrors, lamps, and estate rugs	Export porcelain, English Staffordshire clocks, brass and copper	Baltimore silver and other appropriate accessories
---	--	--

---

1501 Sulgrave Avenue, Mt. Washington Village, Baltimore, MD 21209  
 410-466-0606    [omalleyantiques.com](http://omalleyantiques.com)

Established 1999

# RAW FITNESS

*the way to wellness*

In-home Ladies Personal Fitness Training



**Learn our formula for success...**  
*Become a part of the Raw Fitness  
 F.O.R.C.E. today!*

- F.** Functional training to 'exercise naturally'
- O.** Organic approach to fitness & nutrition
- R.** Results driven program designs
- C.** Customized exercise & nutrition programs
- E.** Enjoyable yet effective workouts!

**5 Free Sessions w/purchase of 24+ sessions**  
Offer expires 08/01/12.

**'For a Woman, by a Woman'**  
[www.RawFitnessNow.com](http://www.RawFitnessNow.com)  
[nmeconi@customizedpt.com](mailto:nmeconi@customizedpt.com)  
**410-274-4839**



# Community Calendar

Institutions in the greater Guilford area offer a wealth of events open to the general public.

## MARCH

**3 Saturday, 1 p.m.**  
Johns Hopkins University, Shriver Hall Auditorium, Hopkins Symphony Orchestra presents its 20th Annual Concert for Children and Families, featuring Stravinsky's Petrouchka, **FREE**

**4 Sunday, 2:00 p.m.**  
Baltimore Museum of Art, Family Workshop: *Stenciled-Patterned Prints*, **FREE**

**Sunday, 3:00 p.m.**  
Johns Hopkins University, Shriver Hall Auditorium, Hopkins Symphony Orchestra presents Samuel Barber: Piano Concerto, Opus 38, Clipper Erickson, piano; and Stravinsky's Petrouchka (pre-concert lecture at 2 p.m.)

**7 Wednesday, 2:00 p.m.**  
Baltimore Museum of Art, Collection Tour: *Treasures of the American Wing*, **FREE**

**11 Sunday, 2:00 p.m.**  
Baltimore Museum of Art, Family Workshop: *Make 3-D Mechanical Creatures*, **FREE**

**Sunday, 3:30 p.m.**  
Second Presbyterian Church, *Community Concerts At Second*, Escher String Quartet, **FREE**

**Sunday, 5:00 p.m.**  
Baltimore Museum of Art, Chamber Jazz Society Concert: *The Walt Weiskopf Quartet featuring Renee Rosnes*

**14 Wednesday, 2:00 p.m.**  
Baltimore Museum of Art, Exhibition Tour: *Embroidered Treasures: Textiles from Central Asia*, **FREE**

**15 Thursday, 1:00 p.m.**  
Baltimore Museum of Art, Third Thursday Curatorial Tour: *Print by Print: Series from Dürer to Lichtenstein*, **FREE**

**18 Sunday, 2:00 p.m.**  
Baltimore Museum of Art, Family Workshop: *Silk-Screened Scenery*, **FREE**

**18 Sunday, 5:30 p.m.**  
Johns Hopkins University, Shriver Hall Auditorium, Shriver Hall Concert Series: Richard Goode, piano

**21 Wednesday, 2:00 p.m.**  
Baltimore Museum of Art, Exhibition Tour: *Print by Print: Series from Dürer to Lichtenstein*, **FREE**

**24 Saturday 1:00 p.m.**  
Baltimore Museum of Art, *African Film Festival Traveling Series*, Free for Members

**25 Sunday, 1:00 p.m.**  
Baltimore Museum of Art, *African Film Festival Traveling Series*, Free for Members

**Sunday, 2:00 p.m.**  
Baltimore Museum of Art, Family Tour: *Lines, Shapes, and Patterns*, **FREE**

**Sunday, 7:30 p.m.**  
Second Presbyterian Church, *Community Concerts At Second*, Chamber Music by Candlelight: Mozart, Poulenc, Francaix, Grieg, **FREE**

**28 Wednesday, 2:00 p.m.**  
Baltimore Museum of Art, Collection Tour: *Paintings in the Cone Collection*, **FREE**

**Wednesday, 6:30 p.m.**  
Evergreen Museum and Library, *The House Beautiful Lecture Series* presents architect and author Hermes Mallea, "Great Houses of Havana: A Century of Cuban Style."

**31 Saturday, 3:00 p.m.**  
Evergreen Museum, Bakst Theater, Music at Evergreen: Narek Arutyunian, clarinet; Steven Beck, piano.

## APRIL

**1 Sunday, 3:00 p.m.**  
Johns Hopkins University, Mattin Center, SDS Room, Hopkins Symphony Orchestra presents a chamber concert.

**15 Sunday, 5:30 p.m.**  
Johns Hopkins University, Shriver Hall Auditorium, Shriver Hall Concert Series: Takacs Quartet

**21 Saturday, 3:00 p.m.**  
Evergreen Museum, Bakst Theater, Music at Evergreen: The Attacca Quartet

**22 Sunday, 3:00 p.m.**  
Johns Hopkins University, Shriver Hall Auditorium, Hopkins Symphony Orchestra, presents Brahms: Symphony No. 1 in C Minor

**Sunday, 3:30 p.m.**  
Second Presbyterian Church, *Community Concerts At Second*, Wonderlic piano finals, **FREE**

**25 Wednesday, 6:30 p.m.**  
Evergreen Museum, *The House Beautiful Lecture Series* presents architect John Tackett, "A Devotion to Classicism..."

**29 Sunday, 7:30 p.m.**  
Second Presbyterian Church, *Community Concerts At Second*, Chamber Music by Candlelight: Barber, Genzmer, Vaughan Williams, **FREE**

## MAY

**20 Sunday, 11:00 a.m.**  
The District IV Federated Garden Club of Maryland and its presenting sponsor The Classic Catering People invite you to attend its Garden Tour. The tour features gardens rarely seen in Roland Park, Homeland and Guilford. Visit [www.baltimorecitygardenclubs.org](http://www.baltimorecitygardenclubs.org) or call Leslie Goldsmith at 410-889-1171.

**Sunday, 3:30 p.m.**  
Second Presbyterian Church, *Community Concerts At Second*, Dolce Suono Trio, **FREE**

## Love Where You Live

**Greater Homewood Community Corporation's 5th Annual Neighborhood Institute: Love Where You Live** is all about learning what you can do to build and strengthen vibrant urban neighborhoods. Join your neighbors on **Saturday, March 24** from 9:00 a.m. to 3:30 p.m. at the Inn at the Colonnade for this exciting series of informative workshops, led by Baltimore's best and brightest activists, artists, educators, and leaders. Workshops will include Event Planning, Creating Community Art, Community Greening, Transforming Schools, Energy Efficiency, and much more. This event is free and lunch is included but space is limited. Register today at [www.greaterhomewood.org/neighborhoodinstitute](http://www.greaterhomewood.org/neighborhoodinstitute).

## New Dog Park at Robert E. Lee

Baltimore's leash law requires a dog to be leashed at all times when off its owners property except when in a designated city off-leash park. Guilford parks are subject to this restriction and cannot be used for free run of a dog.

There is some good news for dogs and owners who want to achieve active dog exercise, Paw Point Dog Park at Robert E. Lee Park officially opened on Saturday, October 15th.

Paw Point is a community-supported dog park providing a safe and controlled environment for dogs to play and exercise. It is a fully fenced one acre area with water access. It is open year round, from sunrise to sunset. There is a code controlled, double gated entrance and access to Lake Roland for dogs that enjoy the water.

The park is a membership only program with an annual cost of \$35 for up to two dogs. Membership also includes an electronic newsletter and advance notice of special events. Annual membership runs from April 1 through March 31.

For more information about Paw Point or to become a member visit <http://pawpoint.org> or call 410-887-4156.

**The Guilford Association, Inc.**

4200 Saint Paul Street

Suite 100

Baltimore, Maryland 21218

# The Guilford News

WINTER 2012

---

## CALENDAR OF EVENTS

March 15	Gardeners of Guilford, Speaker Series <i>The Right Starts for Spring</i>
April 1	Guilford Easter Egg Hunt, Sherwood Gardens
April 22	Gardeners of Guilford, Garden Tour <i>Fruiting Plants</i>
June 3	Guilford Dinner at Dusk

## GARDENERS OF GUILFORD

If you're an avid gardener or if you simply love the beauty of plants, trees and flowers, you're invited to join the Gardeners of Guilford this season for our scheduled events. All interested neighbors are welcome. Contact Pam Hindsley at [PamHindsley@verizon.net](mailto:PamHindsley@verizon.net).



### ADOPT-A-PLOT

The Adopt-a-Plot program is recruiting volunteers to support the gardens this season. You decide what to plant, supply the flowers and care during the summer. Contact Bruce Barnett at [bab@jhu.edu](mailto:bab@jhu.edu)